



FIXNORDIC.DK

# WHEN THE SUN DOESN'T SHINE



## INSTALLATION GUIDELINE ROOF CONSOLE (Cold roof - Board Based Surface)

**FIXNORDIC**  
proof enough.



# Symbol description



Drill Driver with a Ø17 socket



Torch



Socket wrench with at 17 mm socket



Ø25 mm hole saw



Manual handling



Pay attention!



Loosening operation  
(anti clock wise rotation)



Tightening operation  
(clock wise rotation)



# Roof Console cold roof

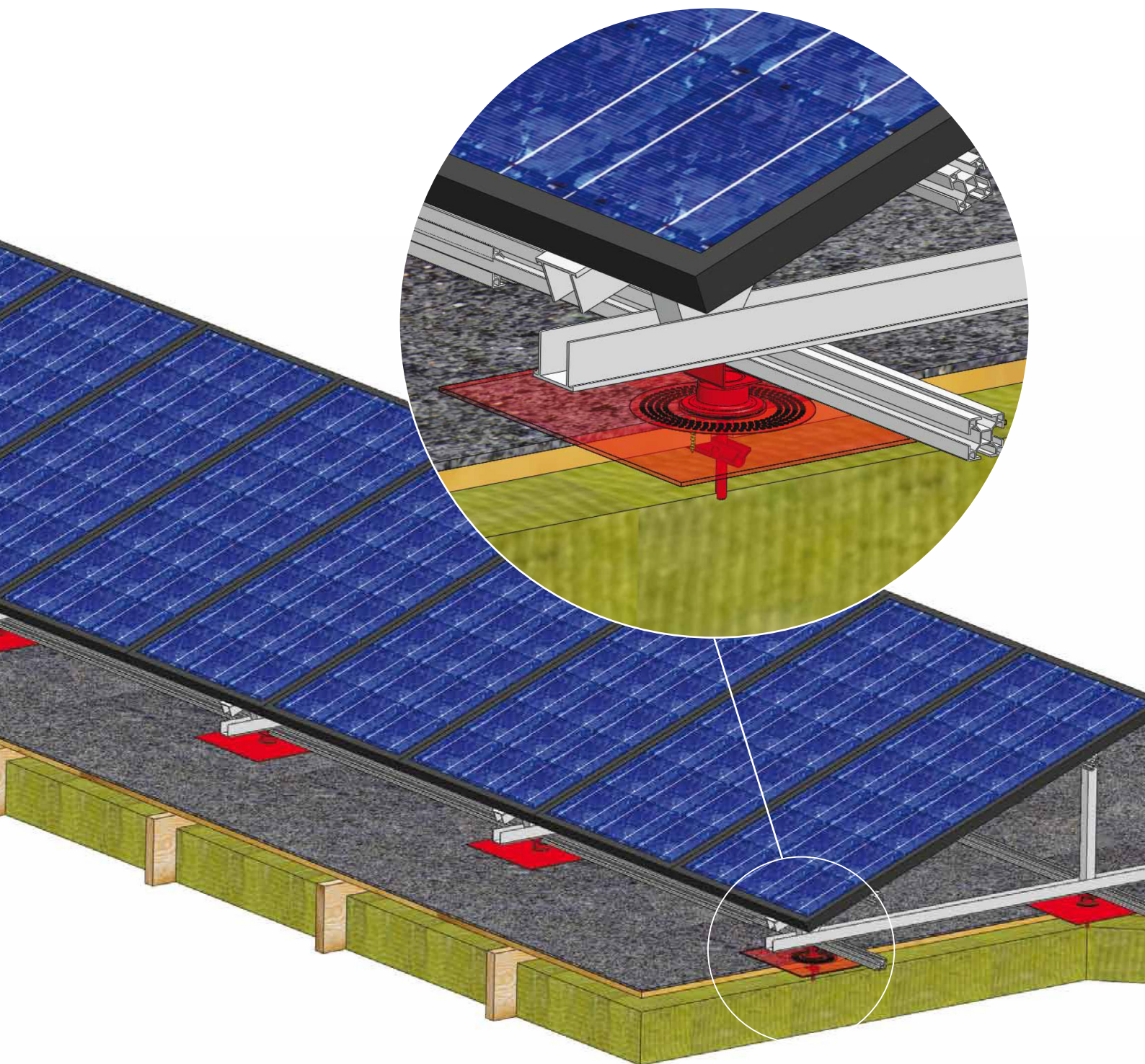

## 1. Surface board drilling

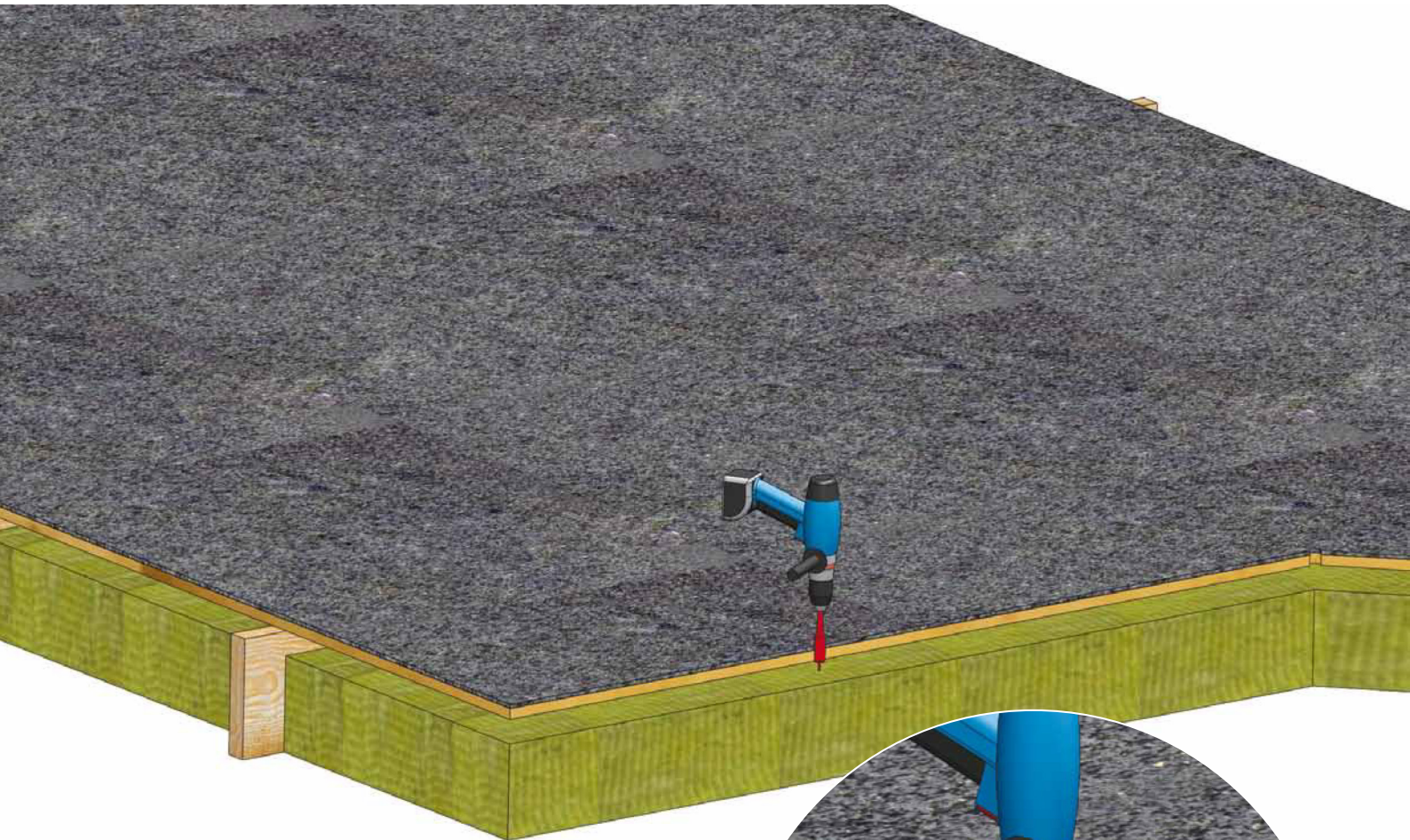

Pay attention!  
The Hole Saw must be capable of sawing into the roofing membrane which may contain small pebbles.

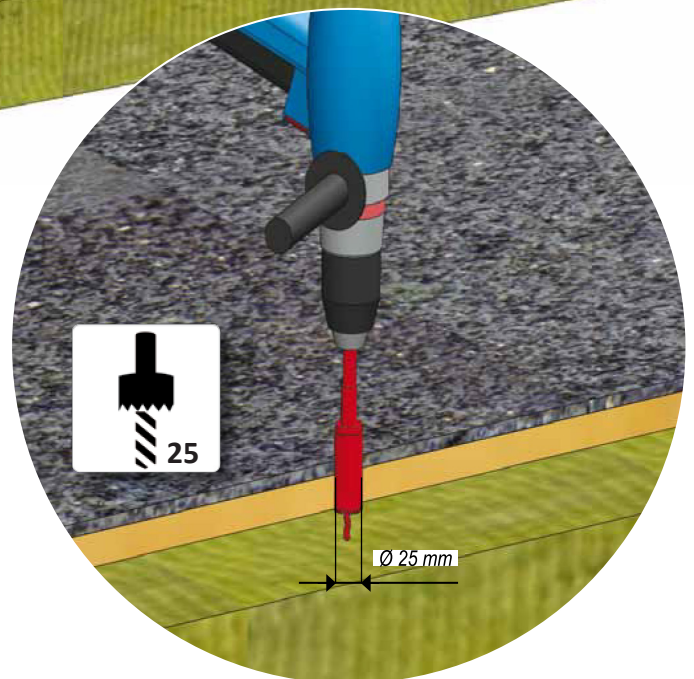

## 2. Anchor /Adapter preassembly

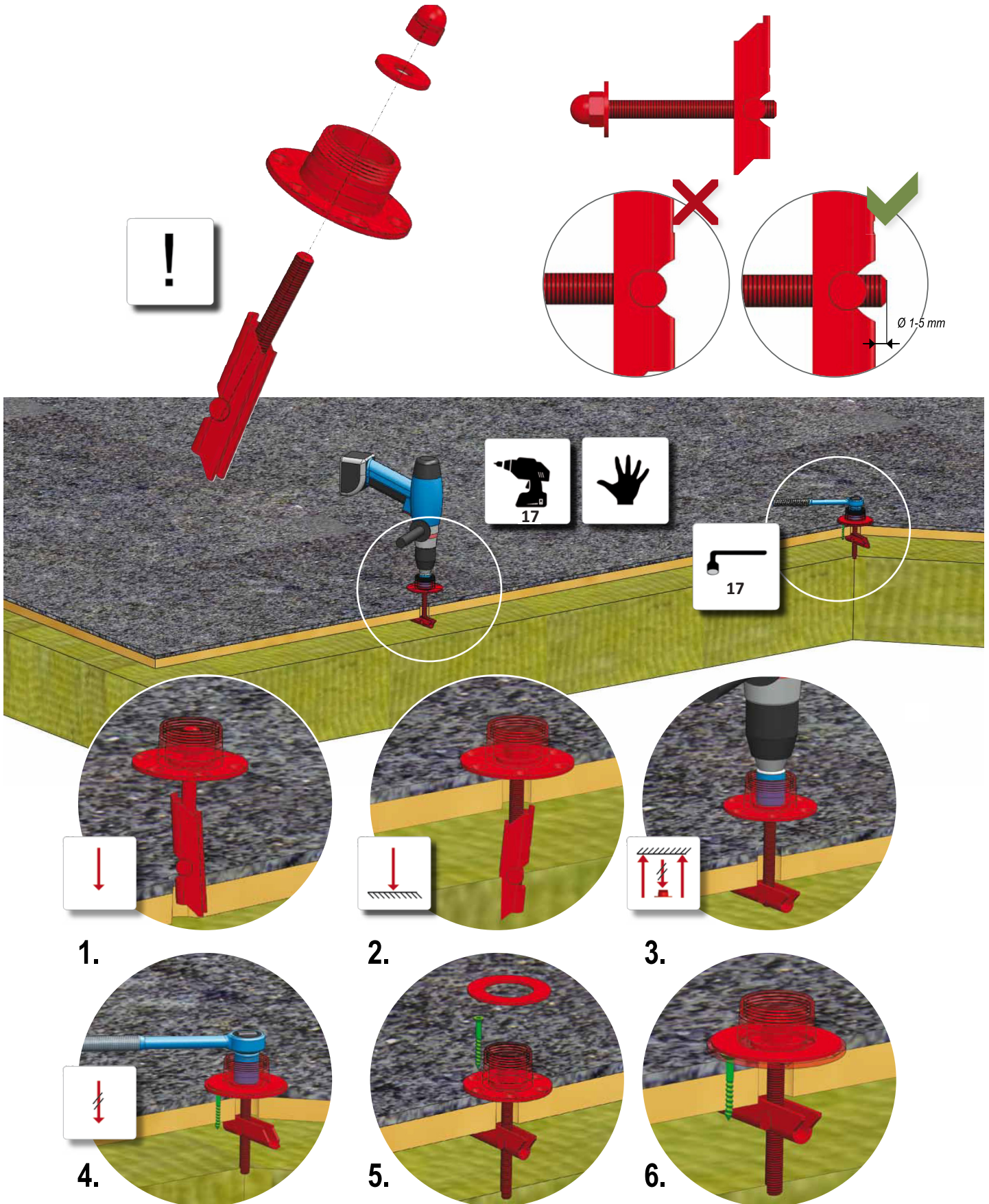

## 3. Fixation of the Console with the Compression Ring

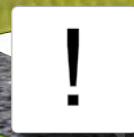
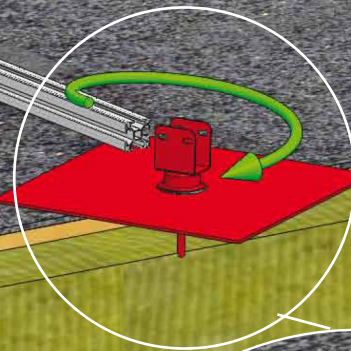
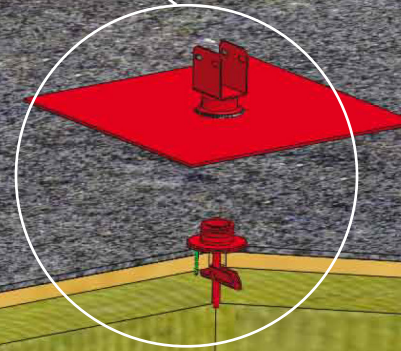
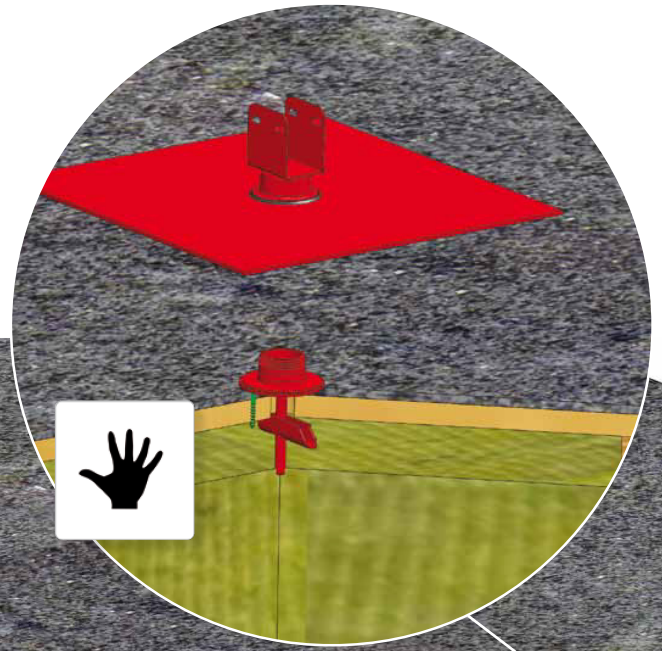

## 4. Roof Console Tightening

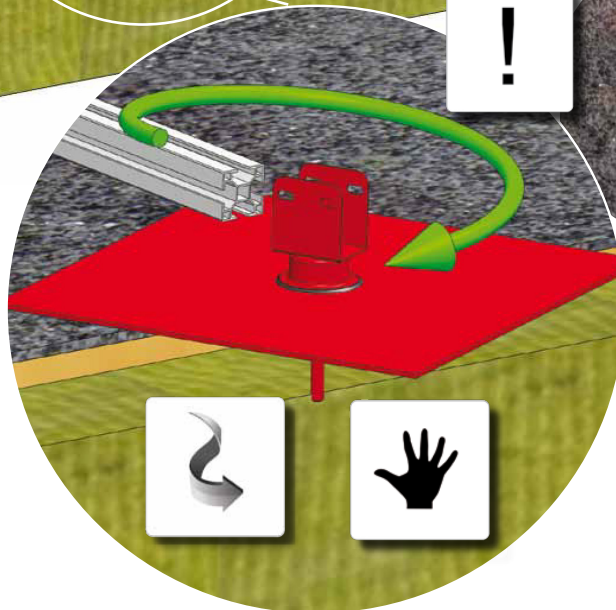

**Pay Attention!**  
The Connection Interface  
must be correctly aligned.



## 5. Torching

