



FIXNORDIC.DK

WHEN THE SUN DOESN'T SHINE



INSTALLATION GUIDELINE ROOF CONSOLE (Cold roof - Wooden Rafter)

FIXNORDIC
proof enough.



Symbol description

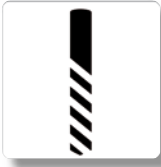

Drill Driver with a Ø6 mm wooden drill



Drill Driver with a TX40 bit driver



Gas torch



Manual handling



Pay attention!



Loosening operation
(anti clock wise rotation)



Tightening operation
(clock wise rotation)



Roof Console cold roof

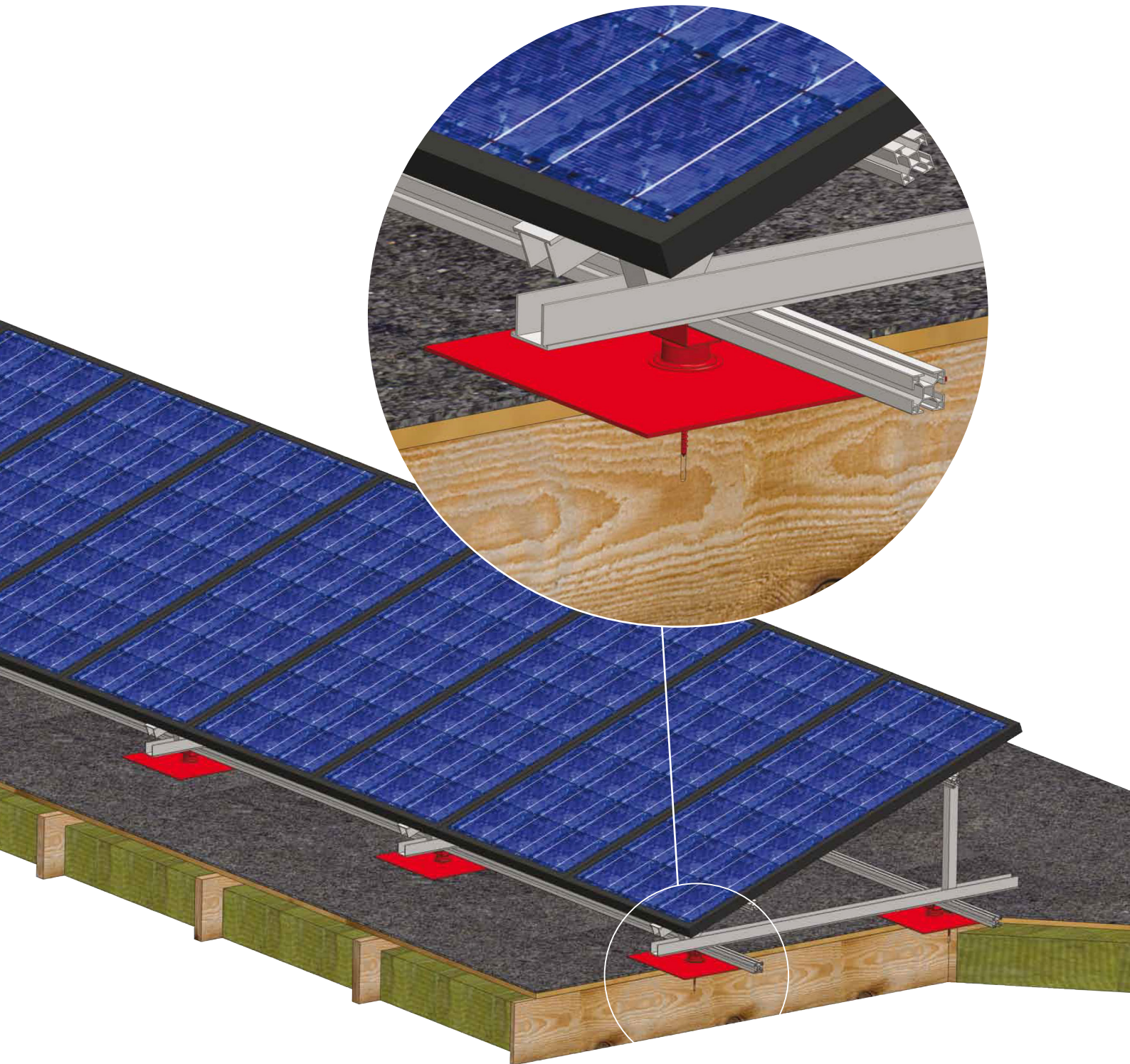

1. Rafter predrilling

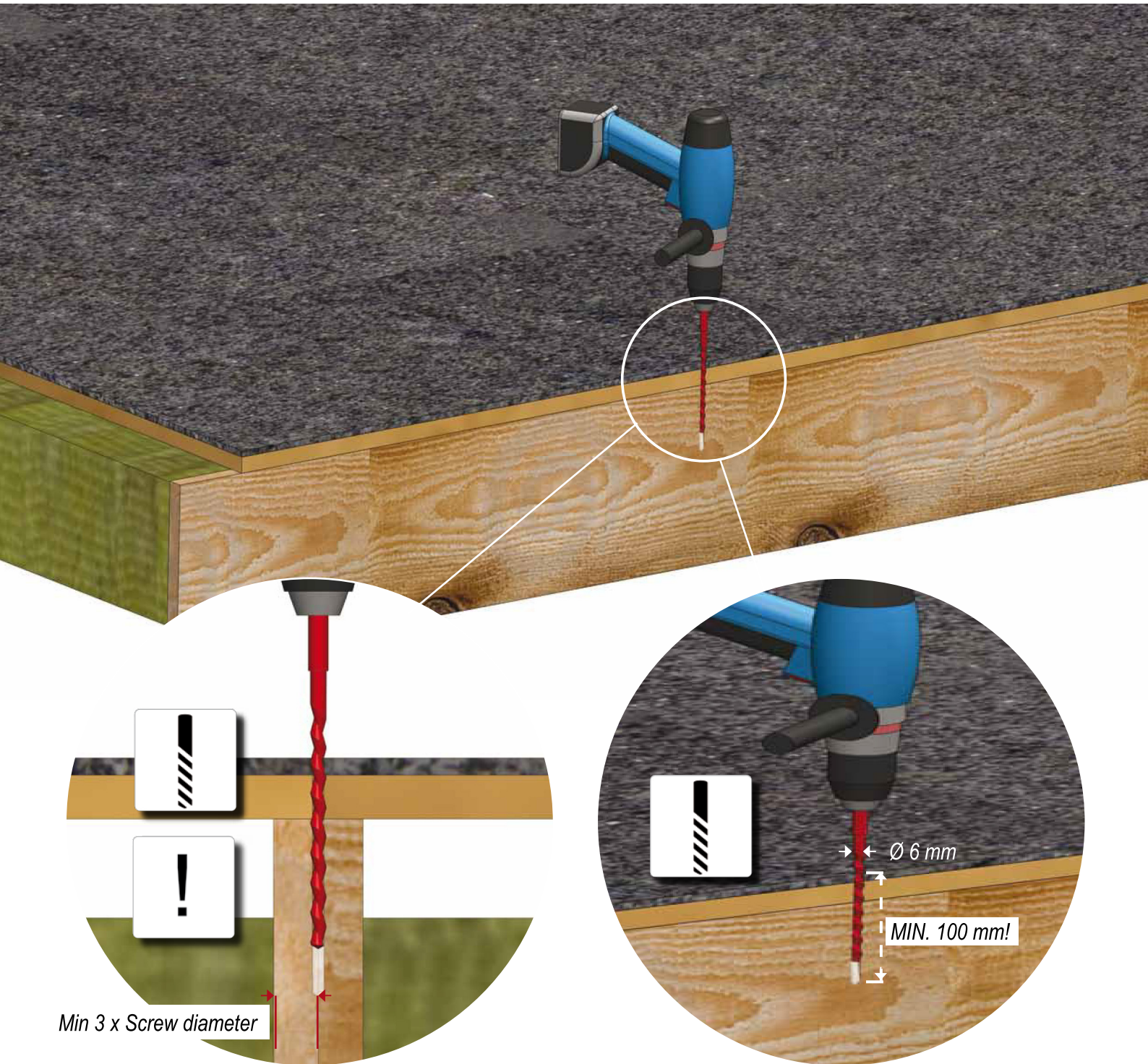

2. Fixation of the Console Adapter



Pay Attention
A standard wooden screw
should be used to fix the
Console Adapter against
rotationel movement during the
installation.

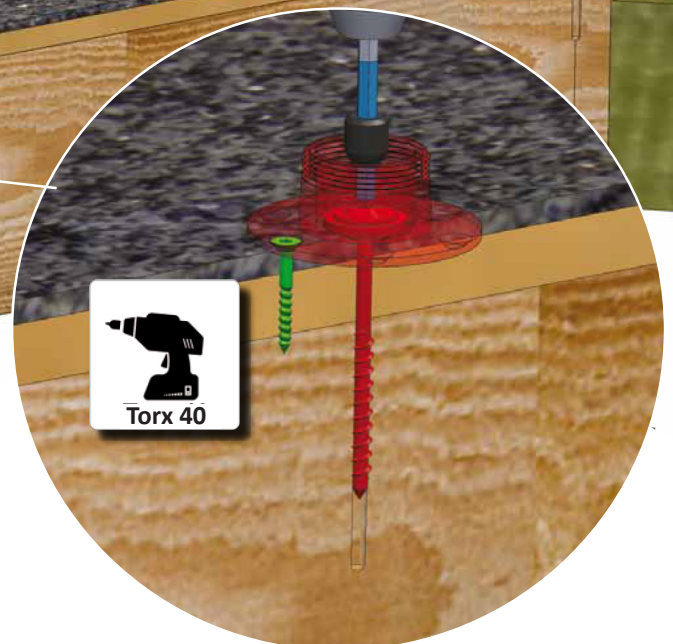
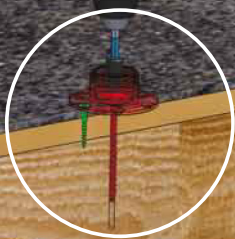
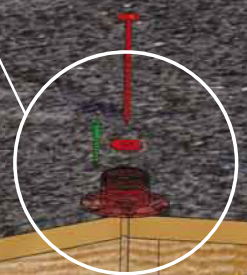
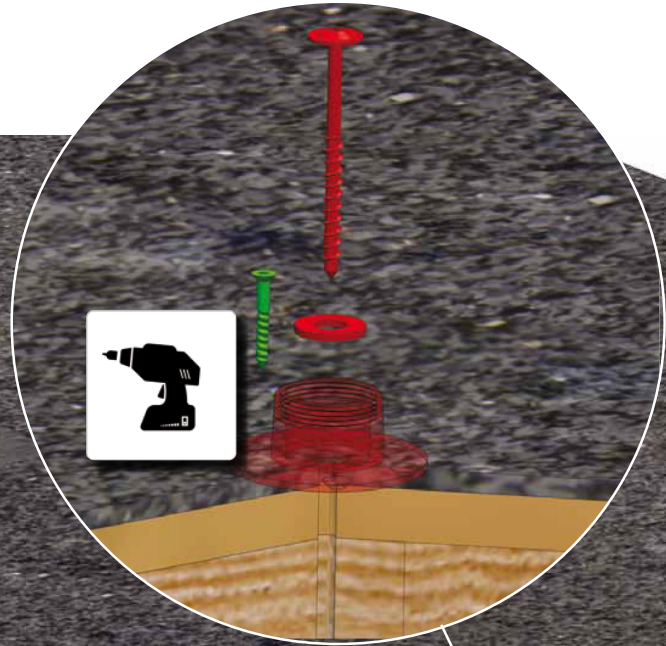

3. Fixation of the Console with the Compression Ring

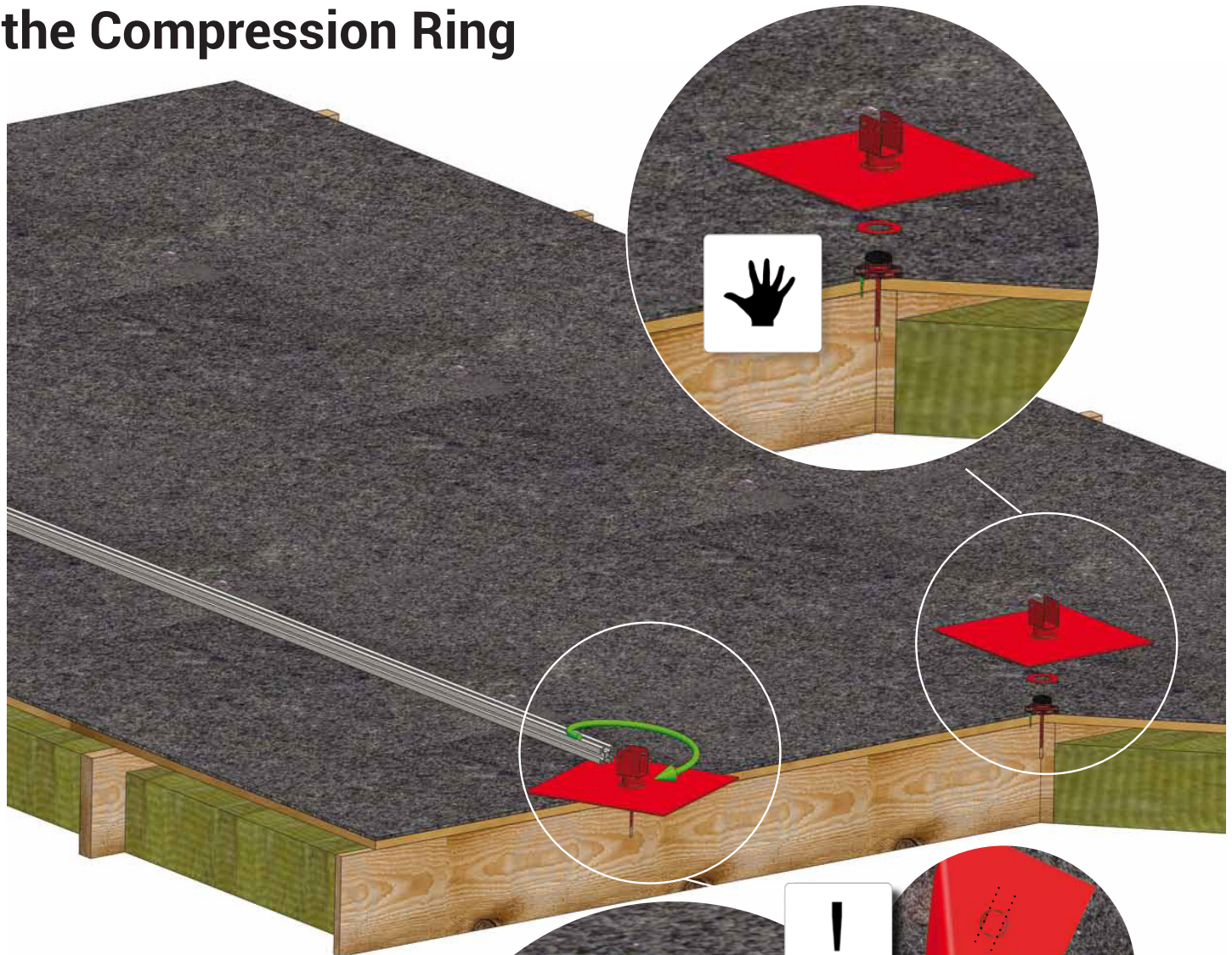

4. Roof Console Tightening

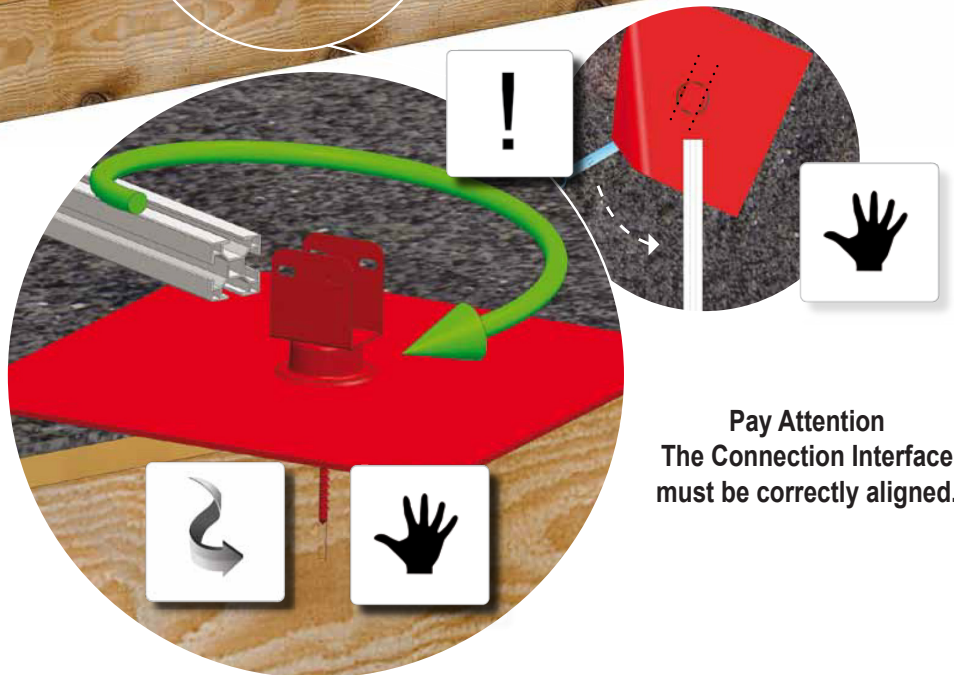

5. Torching

